

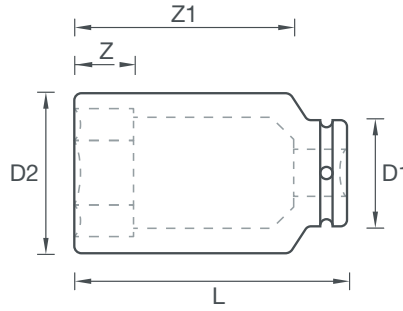



1" KARE GİRİŞLİ AĞIR İŞ LOKMALARI - UZUN 12 KÖŞE METRİK SERİ
DOUBLE HEX IMPACT SOCKETS 1" LONG SERIES METRIC



Ürün Kodu	 Kare Sürücü	 mm	D1 mm	D2 mm	L mm	Z mm	Z1 mm	 KG
SD100-19PL	1"	19	54	35	100	11	71	1,30
SD100-22PL	1"	22	54	37	100	12	71	0,88
SD100-24PL	1"	24	54	38	100	14	68	0,89
SD100-27PL	1"	27	54	44	100	16	68	0,99
SD100-30PL	1"	30	54	50	100	17	68	1,15
SD100-32PL	1"	32	54	52	100	19	68	1,17
SD100-33PL	1"	33	54	54	100	19	68	1,19
SD100-36PL	1"	36	54	57	100	20	68	1,18
SD100-41PL	1"	41	54	63	100	23	67	1,41
SD100-46PL	1"	46	54	69	115	25	82	1,85
SD100-50PL	1"	50	54	75	125	28	93	2,22
SD100-55PL	1"	55	62	81	125	30	93	2,67
SD100-60PL	1"	60	62	87	125	33	93	2,90
SD100-65PL	1"	65	62	94	135	35	105	3,63
SD100-70PL	1"	70	62	100	135	38	105	3,83
SD100-75PL	1"	75	76	107	135	38	105	4,80
SD100-80PL	1"	80	76	113	140	38	108	5,15
SD100-85PL	1"	85	76	117	140	38	100	5,90
SD100-90PL	1"	90	76	124	140	45	99	5,74
SD100-90PL	1"	95	76	129	140	45	98	5,83
SD100-100PL	1"	100	76	136	150	45	98	6,00

BUSSOLE IMPACT 1" - IMPACT SOCKETS 1"

Note: Esecuzioni speciali su richiesta. Tutti i valori indicati possono variare senza preavviso - i valori di peso sono indicativi. Tutte le bussole Blackiron sono personalizzabili con vostro logo aziendale su richiesta.
Special executions upon request. All the dimensions may change without prior notice - Weight values are approximated. All Blackiron impact sockets are customizable with your company logo under request.